



PANGSAPURI PERKHIDMATAN

MENARA A

RESIDENSI PANORAMA SENIBONG

KEMUDAHAN



PELAN ARAS KE-7:KEMUDAHAN

1. GIMNASIUM
2. BILIK SERBAGUNA
3. BILIK AKTIVITI
4. KOLAM RENANG
5. PERMAINAN KANAK-KANAK
6. BILIK PERSALINAN (LELAKI & PEREMPUAN)
7. BILIK MESYUARAT (TINGKAT 1)
8. PEJABAT PENGURUSAN (TINGKAT 1)
9. PUSAT JAGAAN KANAK-KANAK (TINGKAT 1)
10. SURAU (LELAKI & PEREMPUAN – TINGKAT 1)
11. TANDAS
12. RUMAH SAMPAH
13. TEMPAT LETAK KENDERAAN PELAWAT (TINGKAT 1)

MENARA A JENIS A1

LUAS BINAAN : 598 k.p.
HARGA JUALAN : RM452,000.00 (Min) - RM527,000.00 (Maks)
BILANGAN UNIT : 112



MENARA A JENIS A1a

LUAS BINAAN : 764 k.p.
HARGA JUALAN : RM581,000.00 (Min) - RM584,000.00 (Maks)
BILANGAN UNIT : 4



MENARA A
JENIS B1

LUAS BINAAN : 853 k.p.
HARGA JUALAN : RM630,000.00 (Min) - RM724,000.00 (Maks)
BILANGAN UNIT : 125

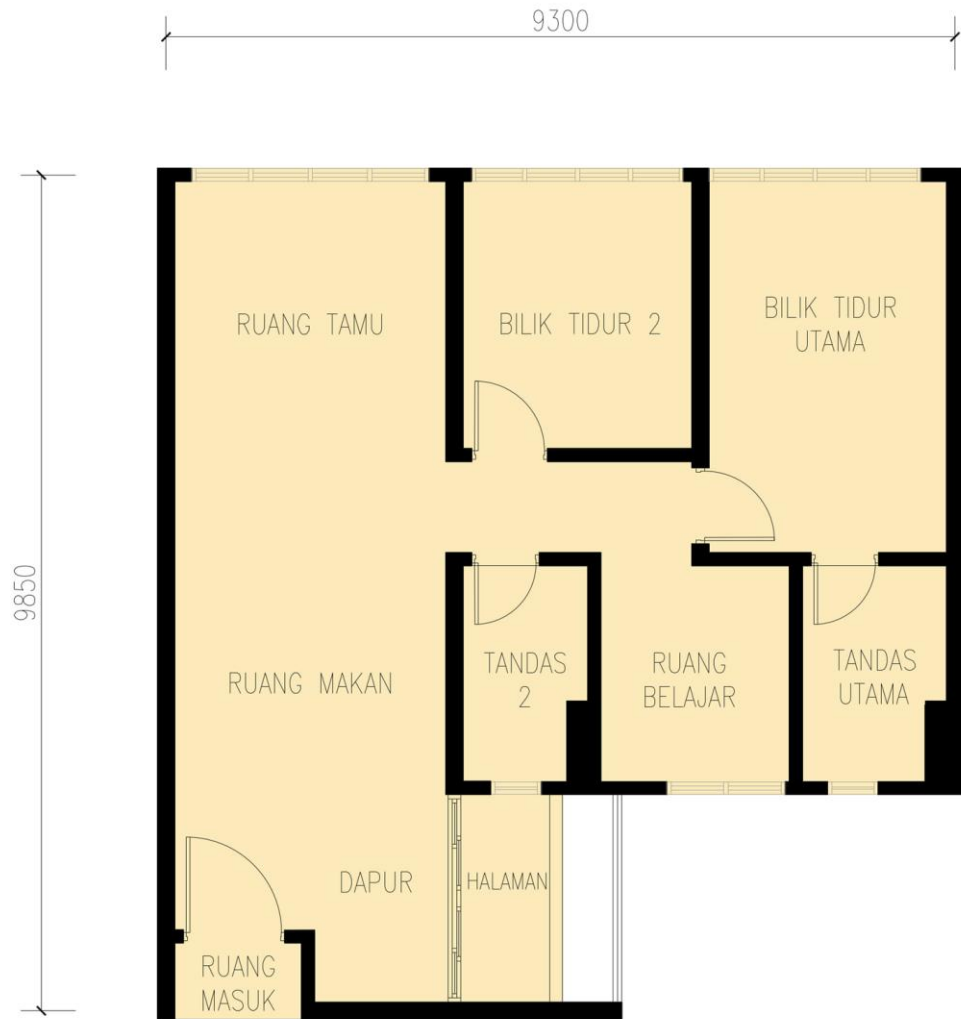

MENARA A
JENIS B1a

LUAS BINAAN : 1,103 k.p.
HARGA JUALAN : RM830,000.00 (Min) - RM837,000.00 (Maks)
BILANGAN UNIT : 5



MENARA A
JENIS B2

LUAS BINAAN : 890 k.p.
HARGA JUALAN : RM746,000.00 (Min) - RM772,000.00 (Maks)
BILANGAN UNIT : 40

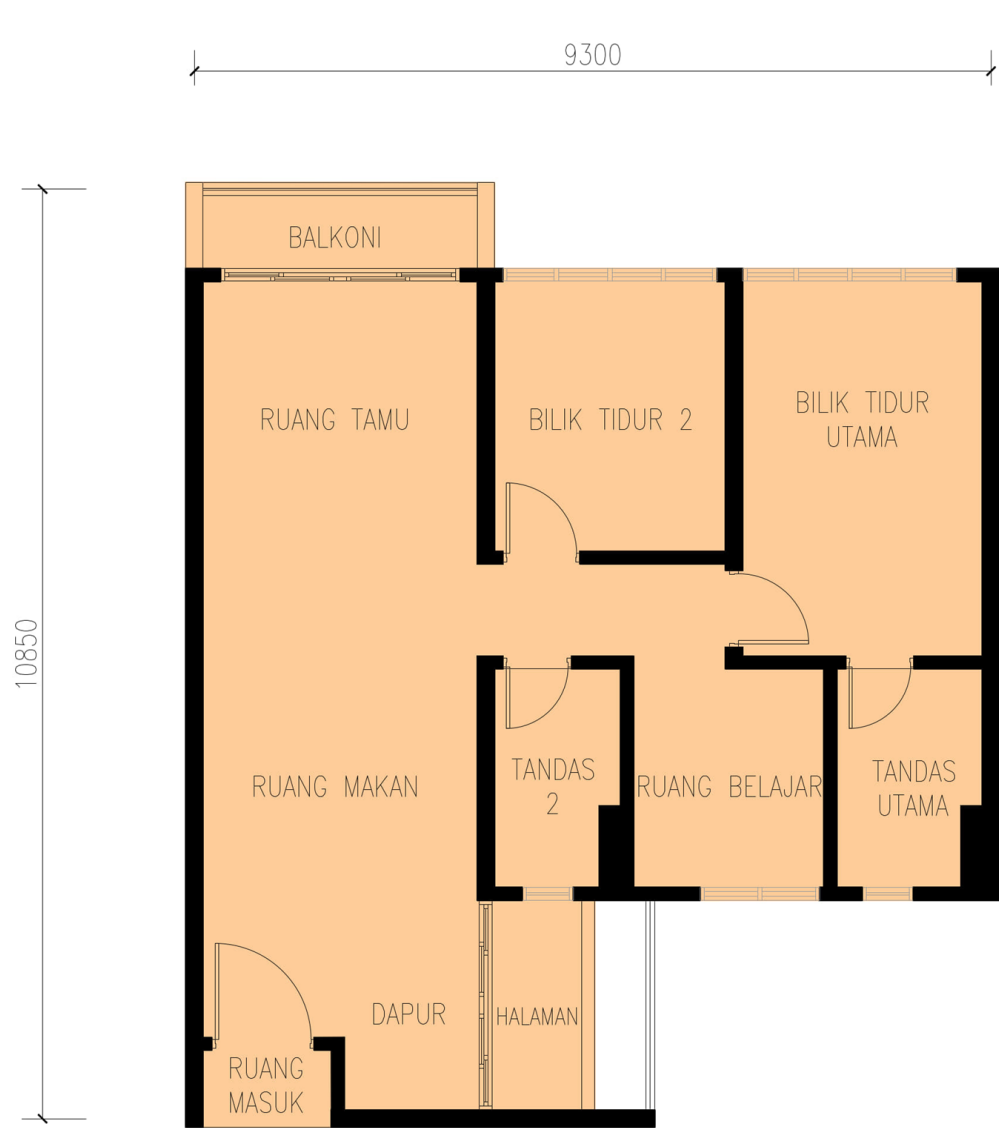

MENARA A
JENIS C1

LUAS BINAAN : 1,007 k.p.
HARGA JUALAN : RM779,000.00 (Min) - RM913,000.00 (Maks)
BILANGAN UNIT : 94



MENARA A JENIS C1a

LUAS BINAAN : 1,198 k.p.
HARGA JUALAN : RM927,000.00 (Min) - RM936,000.00 (Maks)
BILANGAN UNIT : 2



MENARA A JENIS C1b

LUAS BINAAN : 1,007 k.p.
HARGA JUALAN : RM784,000.00 (Min) - RM851,000.00 (Maks)
BILANGAN UNIT : 28



MENARA A JENIS C1c

LUAS BINAAN : 1,163 k.p.
HARGA JUALAN : RM900,000.00 (Min. & Maks.)
BILANGAN UNIT : 1



MENARA A JENIS D1

LUAS BINAAN : 1,349 k.p.
HARGA JUALAN : RM1,191,000.00 (Min. & Maks.)
BILANGAN UNIT : 2



MENARA A
JENIS D2

LUAS BINAAN : 1,288 k.p.
HARGA JUALAN : RM1,131,000.00 (Min) - RM1,135,000.00 (Maks)
BILANGAN UNIT : 2

MENARA A
JENIS D2a

LUAS BINAAN : 1,288 k.p.
HARGA JUALAN : RM1,135,000.00 (Min. & Maks.)
BILANGAN UNIT : 1

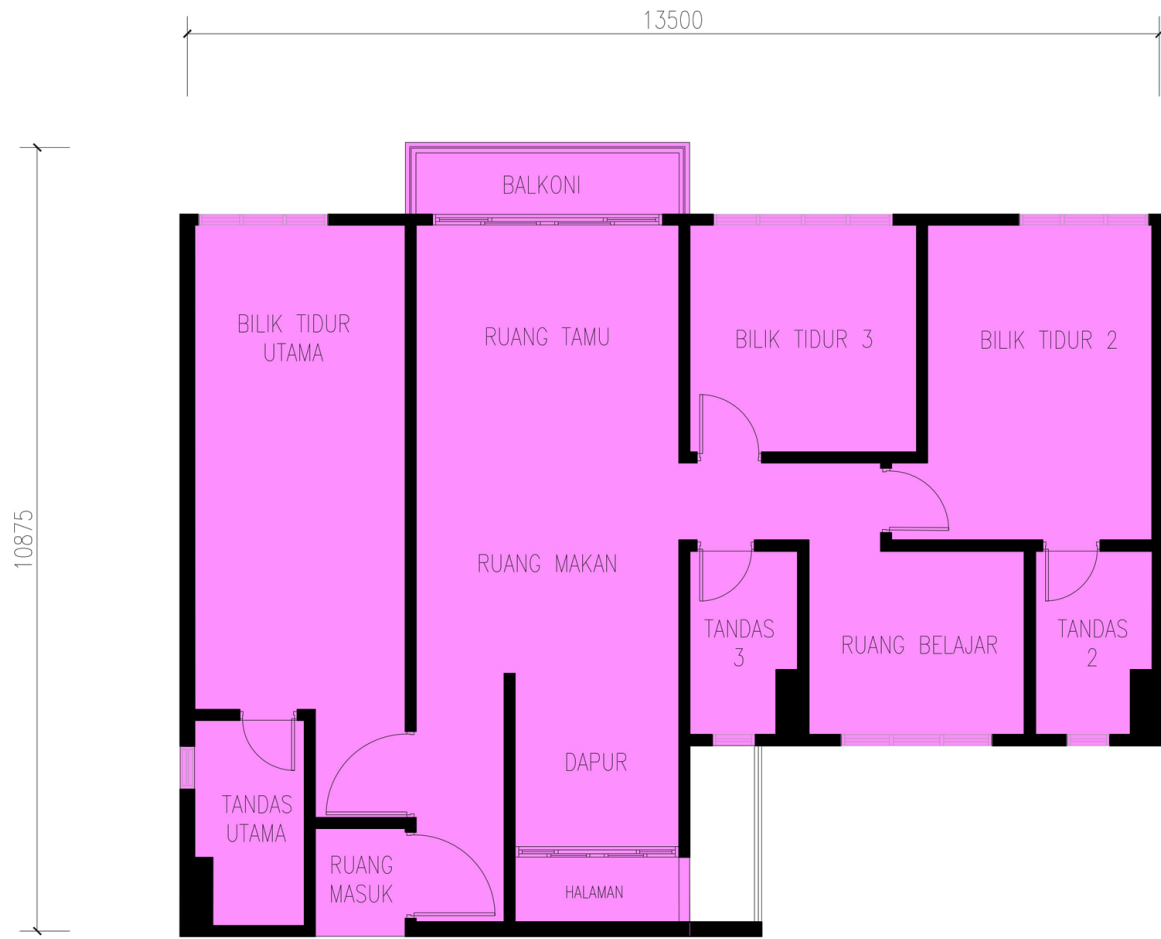

SPESIFIKASI MENARA A

JENIS A1, A1a, B1, B1a, B2, C1, C1a, C1b, C1c, D1, D2 & D2a

BIL.	SPESIFIKASI	JENIS A1	JENIS A1a	JENIS B1	JENIS B1a	JENIS B2	JENIS C1	JENIS C1a	JENIS C1b	JENIS C1c	JENIS D1	JENIS D2	JENIS D2a
1	STRUKTUR	KONKRIT BERTETULANG											
2	DINDING	BATU BATA / KONKRIT BERTULANG											
3	PERLINDUNGAN ATAP	BUMBUNG KONKRIT BERTULANG											
4	RANGKA BUMBUNG	KONKRIT BERTETULANG											
5	SILING	LEPAAN 'SKIM' / SILING 'PLASTER'											
6	TINGKAP	TINGKAP KACA BERBINGKAI ALUMINIUM											
7	PINTU	PINTU KACA BERBINGKAI ALUMINIUM / PINTU KAYU 'FLUSH' / PINTU RINTANGAN API (PINTU MASUK UNIT)											
8	KEKUNCI	SET KUNCI TERPILIH YANG BERKUALITI											
9	KEMASAN DINDING	LEPAAN 'SKIM' DAN CAT											
	BILIK MANDI	JUBIN											
	DAPUR	JUBIN											
10	KEMASAN LANTAI	JENIS A1	JENIS A1a	JENIS B1	JENIS B1a	JENIS B2	JENIS C1	JENIS C1a	JENIS C1b	JENIS C1c	JENIS D1	JENIS D2	JENIS D2a
	RUANG MASUK / RUANG TAMU / RUANG MAKAN / DAPUR	JUBIN	JUBIN	JUBIN	JUBIN	JUBIN	JUBIN	JUBIN	JUBIN	JUBIN	JUBIN	JUBIN	JUBIN
	BILIK TIDUR UTAMA, 1, 2, 3 & 4	LANTAI 'LAMINATED'	LANTAI 'LAMINATED'	LANTAI 'LAMINATED'	LANTAI 'LAMINATED'	LANTAI 'LAMINATED'	LANTAI 'LAMINATED'	LANTAI 'LAMINATED'	LANTAI 'LAMINATED'	LANTAI 'LAMINATED'	LANTAI 'LAMINATED'	LANTAI 'LAMINATED'	LANTAI 'LAMINATED'
	RUANG BELAJAR	LANTAI 'LAMINATED'	LANTAI 'LAMINATED'	LANTAI 'LAMINATED'	LANTAI 'LAMINATED'	LANTAI 'LAMINATED'	-	-	-	-	-	LANTAI 'LAMINATED'	LANTAI 'LAMINATED'
	TANDAS / HALAMAN	JUBIN	JUBIN	JUBIN	JUBIN	JUBIN	JUBIN	JUBIN	JUBIN	JUBIN	JUBIN	JUBIN	JUBIN
	A/C LEDGE	LANTAI SIMEN	LANTAI SIMEN	LANTAI SIMEN	LANTAI SIMEN	LANTAI SIMEN	LANTAI SIMEN	LANTAI SIMEN	LANTAI SIMEN	LANTAI SIMEN	LANTAI SIMEN	LANTAI SIMEN	LANTAI SIMEN
	BALKONI	-	-	-	-	JUBIN	JUBIN	-	JUBIN	-	JUBIN	JUBIN	JUBIN
RUANG PERSENDIRIAN TERTUTUP	-	JUBIN	-	JUBIN	-	-	-	JUBIN	-	JUBIN	-	-	-
11	PEMASANGAN ALAT SANITARI	SET SANITARI TERPILIH YANG BERKUALITI											
12	PEMASANGAN ELEKTRIK	JENIS A1	JENIS A1a	JENIS B1	JENIS B1a	JENIS B2	JENIS C1	JENIS C1a	JENIS C1b	JENIS C1c	JENIS D1	JENIS D2	JENIS D2a
	PUNCA KUASA LAMPU	7 NOS	8 NOS	10 NOS	12 NOS	11 NOS	11 NOS	12 NOS	11 NOS	11 NOS	14 NOS	14 NOS	14 NOS
	PUNCA KUASA KIPAS	3 NOS	3 NOS	4 NOS	4 NOS	4 NOS	4 NOS	4 NOS	4 NOS	4 NOS	5 NOS	5 NOS	5 NOS
	PUNCA KUASA SOKET	10 NOS	11 NOS	11 NOS	12 NOS	11 NOS	11 NOS	12 NOS	11 NOS	12 NOS	11 NOS	12 NOS	13 NOS
	PUNCA KUASA TV	1 NOS	1 NOS	1 NOS	1 NOS	1 NOS	1 NOS	1 NOS	1 NOS	1 NOS	2 NOS	2 NOS	2 NOS
	PUNCA KUASA PENGHAWA DINGIN	3 NOS	3 NOS	4 NOS	4 NOS	4 NOS	4 NOS	4 NOS	4 NOS	4 NOS	5 NOS	5 NOS	5 NOS
	PUNCA KUASA ALAT PEMANAS AIR	1 NOS	1 NOS	2 NOS	2 NOS	2 NOS	2 NOS	2 NOS	2 NOS	2 NOS	3 NOS	3 NOS	3 NOS
	PUNCA KUASA LOCENG	1 NOS	1 NOS	1 NOS	1 NOS	1 NOS	1 NOS	1 NOS	1 NOS	1 NOS	1 NOS	1 NOS	1 NOS
	PUNCA KUASA INTERKOM	1 NOS	1 NOS	1 NOS	1 NOS	1 NOS	1 NOS	1 NOS	1 NOS	1 NOS	1 NOS	1 NOS	1 NOS
PUNCA KUASA KIPAS PENGUDARAAN	1 NOS	1 NOS	-	-	-	1 NOS	1 NOS	1 NOS	1 NOS	2 NOS	-	-	
13	KABEL TELEFON DALAMAN SOKET DINDING OPTIK GENTIAN	1 NOS	1 NOS	1 NOS	1 NOS	1 NOS	1 NOS	1 NOS	1 NOS	1 NOS	1 NOS	1 NOS	1 NOS
14	SISTEM PENYEMBUR AIR AUTOMATIK	DISEDIAKAN											

Pemaju:
SENIBONG HILLS SDN BHD
201201027041 (1011531-T)
N-01, Block N, Pinggiran Senibong,
No. 1, Persiaran Senibong, Teluk Senibong,
81750 Masai, Johor, Malaysia.

T +607 382 0330
www.senibongcove.my

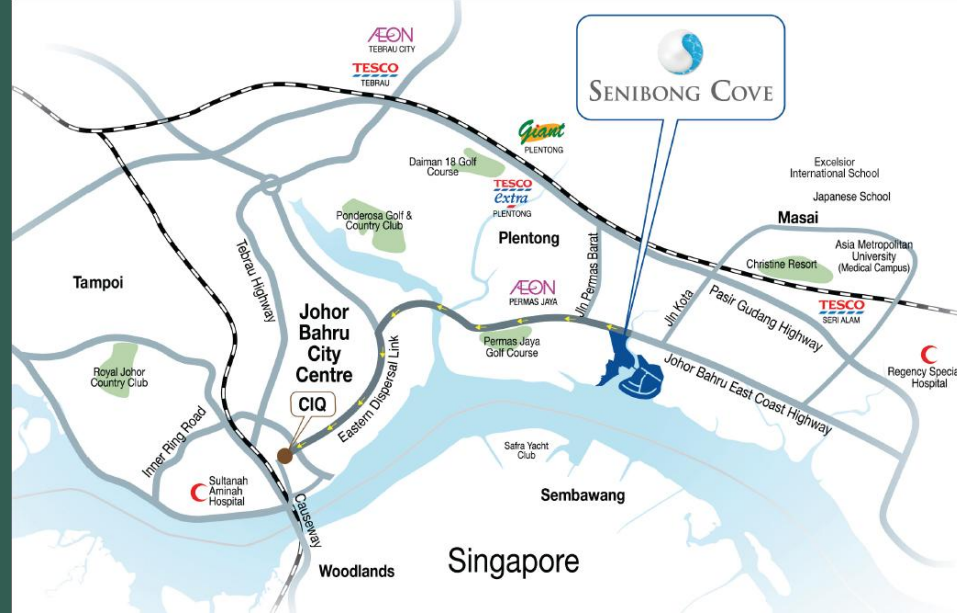

No. Lesen Pemaju: 14523/08-2028/1047(A) • Tempoh Sah: 21/08/2023 - 20/08/2028 • No. Permit Iklan & Jualan: XXXXXXXXXX • Tempoh Sah: XXXXXX • Jenis Bangunan: Fasa 1 • Menara A • Pangsapuri Perkhidmatan • Jumlah Unit: 416 • Harga Jualan: (Min.) RM452,000.00 - (Maks.) RM1,191,000.00 • Pihak Berkuasa Meluluskan: Majlis Bandaraya Johor Bahru • No. Rujukan Pelan Bangunan: MBBJ/U/2025/14/BGN/32/KOM • Tarikh Dijangka Siap: Mac 2029 • Pegangan Tanah: Kekal • Bebanan Tanah: AmBank (M) Berhad • Jumlah tempat letak kereta Menara A: 551 • 15% Diskaun untuk Bumiputera

Sekatan-Sekatan Kepentingan:

- i. Tuan punya tanah tidak dibenarkan menawarkan atau menjual unit-unit (parcels) bangunan yang akan dibina di atas tanah ini melainkan bangunan telah mula dibina mengikut pelan yang diluluskan oleh Pihak Berkuasa Tempatan yang berkenaan.
- ii. Petak-petak bangunan yang didirikan di atas tanah ini apabila sahaja bertukar miliknya kepada seorang Bumiputera/ Syarikat Bumiputera maka tidak boleh terkemudian daripada itu dijual, dipajak atau dipindahmilik dengan apa cara sekalipun kepada orang Bukan Bumiputera/ Syarikat Bukan Bumiputera tanpa persetujuan Pihak Berkuasa Negeri.
- iii. Petak-petak bangunan yang didirikan di atas tanah ini tidak boleh dijual atau dipindahmilik dengan apa cara sekalipun kepada Bukan Warganegara/ Syarikat Asing tanpa persetujuan Pihak Berkuasa Negeri.

IKLAN INI TELAH DILULUSKAN OLEH JABATAN PERUMAHAN NEGARA.

MAKLUMAT PEMAJUAN DAN IKLAN YANG DILULUSKAN BOLEH DISEMAK DI PORTAL TEDUH.KPKT.GOV.MY

SEBUAH PROJEK DARIPADA:





Hillview
Senibong Cove

Floor Plan - Tower 1



Master Bedroom | Type B1

Type A1

598 sqft



Compact and convenient, ideal for working professionals and young couples.

TOWER 1 -
Typical Floor Plan (Level 8-35)

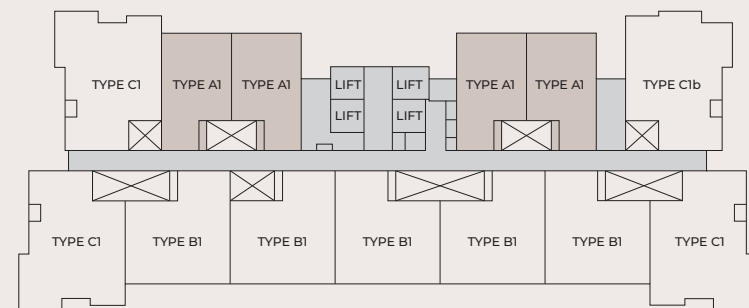

10225



Type A1a

764 sqft



Close-knit, cosy layout, ideal for young families.

TOWER 1 -
Typical Floor Plan (Level 7)

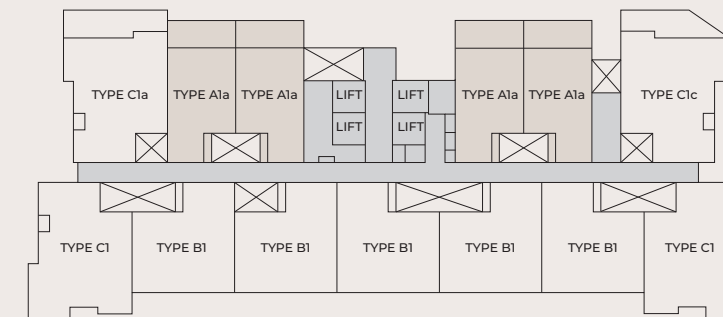

12725



Type B1

853 sqft



Close-knit, cosy layout, ideal for young families.

TOWER1 -
Typical Floor Plan (Level 2-34)

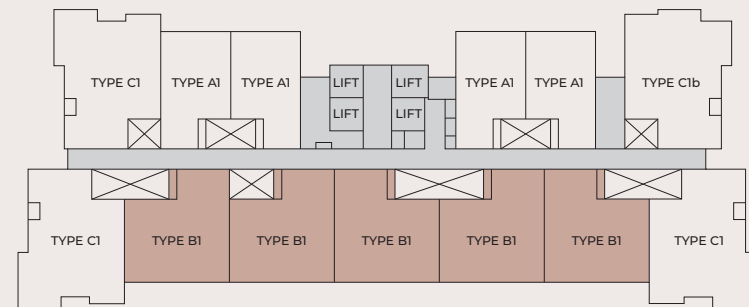

Type B1a

1,103 sqft



Close-knit, cosy layout, ideal for young families.

TOWER1 -
Typical Floor Plan (Level 1)

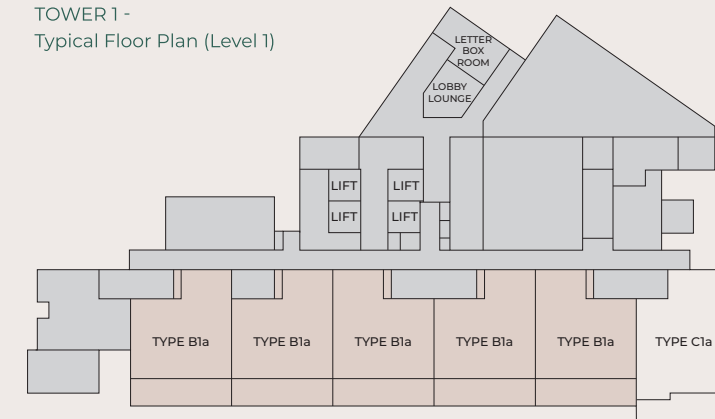

Type B2

890 sqft

 2+1 Bedrooms  2 Baths

Cosy spaces with a balcony for natural sunlight, views and ventilation.

TOWER 1 -
Typical Floor Plan (Level 27-34)

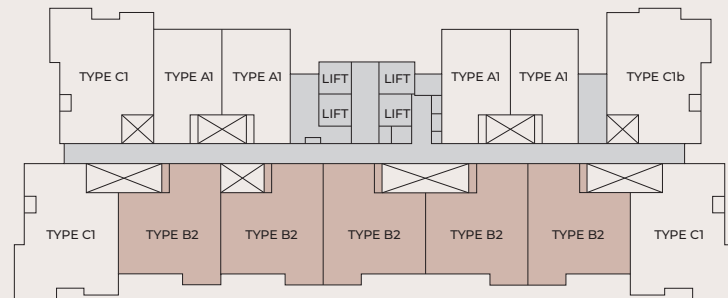

Type C1

1,007 sqft

 3 Bedrooms  2 Baths

Comfortable, adaptable layout, ideal for growing families.

TOWER 1 -
Typical Floor Plan (Level 2-34) Sea View
(Level 8-35) Facilities View

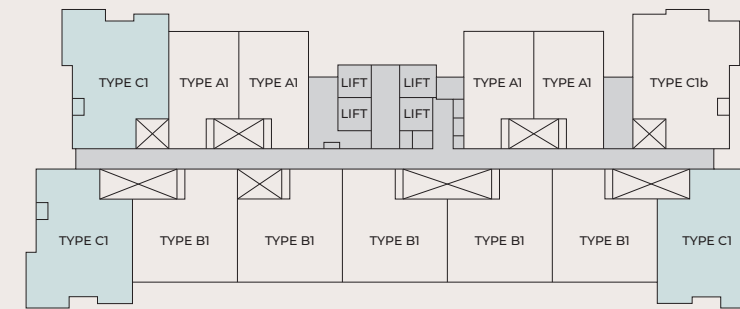

Type C1a

1,198 sqft

3 Bedrooms 2 Baths

Comfortable, adaptable layout, ideal for growing families.

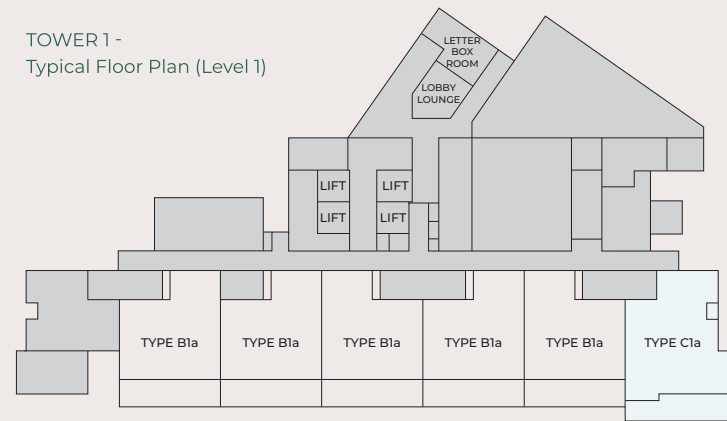

Type C1b

1,007 sqft

3 Bedrooms 2 Baths

Comfortable, adaptable layout, ideal for growing families.

TOWER 1 - Typical Floor Plan (Level 8-35)

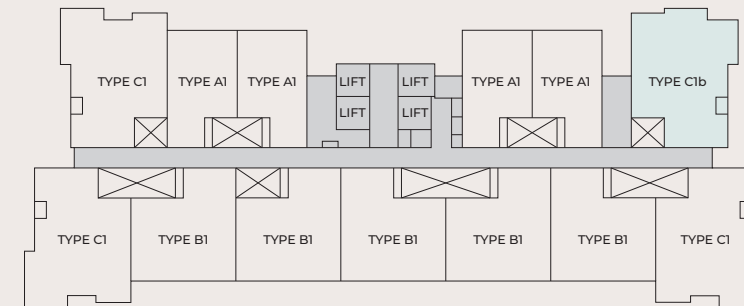

Type C1c

1,163 sqft



Comfortable, adaptable layout, ideal for growing families.

TOWER 1 -
Typical Floor Plan (Level 7)

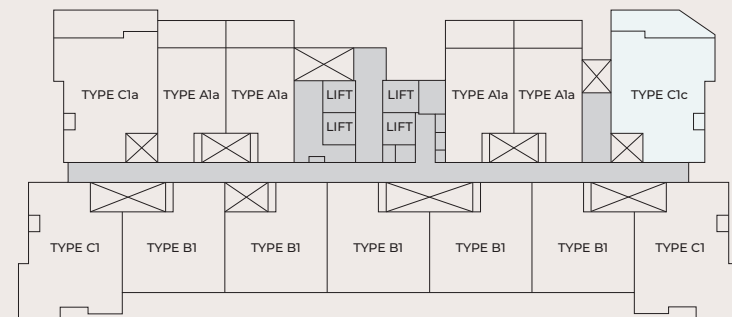

9300

13650



Type D1 | Dual Key

1,349 sqft



Largest unit type with dual key access, ideal for investment.

TOWER 1 -
Typical Floor Plan (Level 35)

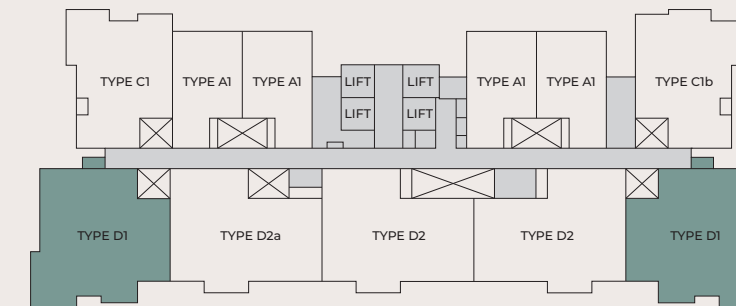

12300

12175



Type D2 | Dual Key

1,288 sqft



Spacious suites, ideal for multi-generational families or investment property.

TOWER1 - Typical Floor Plan (Level 35)

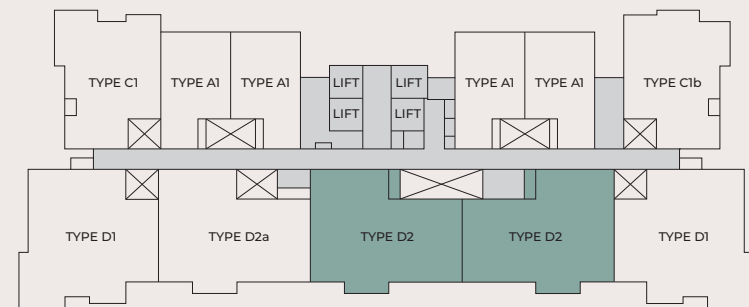

Type D2a | Dual Key

1,288 sqft



Spacious suites, ideal for multi-generational families or investment property.

TOWER1 - Typical Floor Plan (Level 35)

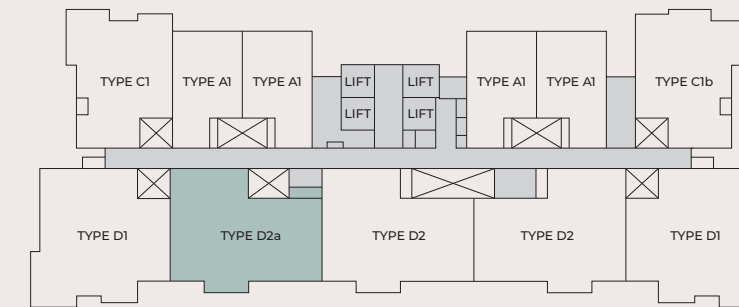

A Project By:



Developed By:

Senibong Hills Sdn Bhd 201201027041 (1011531-T)

N-01, Blok N, Pinggiran Senibong,
No. 1, Persiaran Senibong, Teluk Senibong,
81750 Masai, Johor, Malaysia.

T +60 7 382 0330
F +60 7 382 2600
E enquiries@wmsenibong.com.my

senibongcove.my

SenibongCoveMalaysia senibongcovemalaysia

Senibong Cove Sales Gallery

• Developer's License No: 14523/08-2028/1047(A) • Validity Period: 21/08/2023 – 20/08/2028 • Advertisement & Sales Permit No.: XXXXXXXXXXXXXXXXXXXX • Validity Period: XXXXXXXXXXXXXXXXXXXX • Building Type: Tower A: Serviced Apartment
• Total Units: 416 • Selling Price: RM452,000.00 (min) – RM1,191,000.00 (max) • Approving Authority: Majlis Bandaraya Johor Bahru • Reference No.: MJB/B/U/2025/14/BGN/32/KOM • Land Tenure: Freehold • Land Encumbrances: AmBank (M) Berhad
• Expected Date of Completion: March 2029 • Total Car Park Allocation: Tower A: 551 • 15% discount for Bumiputera

Restriction in interest:

- Tuan punya tanah tidak dibenarkan menawarkan atau menjual unit-unit (parcels) bangunan yang akan dibina di atas tanah ini melainkan bangunan telah mula dibina mengikut pelan yang diluluskan oleh Pihak Berkuasa Tempatan yang berkenaan.
- Petak-petak bangunan yang didirikan di atas tanah ini apabila sahaja bertukar miliknya kepada seorang Bumiputera/Syarikat Bumiputera maka tidak boleh terkemudian daripada itu dijual, dipajak atau dipindahmilik dengan apa cara sekalipun kepada orang Bukan Bumiputera/Syarikat Bukan Bumiputera tanpa persetujuan Pihak Berkuasa Negeri.
- Petak-petak bangunan yang didirikan di atas tanah ini tidak boleh dijual atau dipindahmilik dengan apa cara sekalipun kepada Bukan Warganegara/Syarikat Asing tanpa persetujuan Pihak Berkuasa Negeri.

THIS ADVERTISEMENT HAS BEEN APPROVED BY THE NATIONAL HOUSING DEPARTMENT.
DEVELOPMENT INFORMATION AND APPROVED ADVERTISEMENT CAN BE VIEWED THROUGH THE TEDUH.KPKT.GOV.MY PORTAL



Hillview
Senibong Cove

Sky Homes Redefined

Where Nature Meets Elevated Living



Hillview

Senibong Cove



Senibong Cove Retail Village

The WaterEdge Apartments

Senibong Cove Marina

The WaterEdge Residences

Central Park

Entry Park

Senibong Mangrove

Island Park

Waterway Peaks

The Hills Residences

C4 Apartments

C5 Apartments

Summit @ Lagoon Residences

Lagoon Residences

Lagoon Park

Water Linear Park

Waterway Residences

Isola Mansions

Isola Grandeur

Isola Villas

Isola Coast

The Heart of Senibong Cove

A Vibrant Waterfront Community

A new project arises in Senibong Cove, the iconic 250-acre, multi award-winning waterfront development in Masai, Johor. Designed in harmony with nature and enhanced by thoughtfully crafted innovations, this exciting sky-rise residence is the first of its kind in Senibong Cove. It offers contemporary comforts, privacy, and security, all while remaining connected to the exclusive neighbourhood below.

Just minutes away, residents can enjoy the lush expanses of the Central Park, the 50-berth Marina with its water sports facilities, and the Senibong Retail Village; home to a curated selection of dining and lifestyle experiences.

Welcome to **Hillview** – a vibrant leisure community, a modern haven of tranquility.



A Natural Rhythm of Life

Homes Close To The Coast

Like rivers finding their flow, life at Hillview moves with ease and balance. Set on 5.77 acres and surrounded by greenery, it is a sanctuary for those who value beauty, serenity, and connection.

Thoughtfully crafted with a distinctive zig-zag architectural design, the three towers are positioned to maximise unblocked coastal and city views for every home. From modern comforts to sweeping panoramas, Hillview offers a lifestyle that is both grounding and inspiring — crafted for families, professionals, and individuals alike



Beauty, Artistry & Purpose

Well-Planned Design & Craftmanship

Hillview is more than a residence — it is a crafted experience in modern placemaking. Every detail has been thoughtfully considered, from its striking architectural presence to the seamless integration of space, light, and abundant greenery. Built with precision and care, it reflects timeless craftsmanship where beauty and functionality exist in perfect balance.

Key Highlights



Freehold Ownership



24-Hour Security



Resort-Style Facilities



Exclusive Drop-Off Foyer



Gold Rating



Unique & Modern Facade



Efficient Layouts



EV Charging Station



Shuttle Services to RTS Station

Making An Impression

Main Entrance & Spacious Drop-Off Foyer

Hillview welcomes you home with a grand entrance statement, where modern architecture meets the warmth of lush landscaping. The spacious foyer sets the tone for refined living — stylish, welcoming, and embraced by nature's calming presence.



Drop-Off Foyer



Main Entrance

Play & Relaxation

Pool & Playground

Residents can enjoy simple pleasures within thoughtfully designed outdoor spaces created for all ages. A refreshing dip in the jacuzzi offers relaxation, while a 50-metre Olympic-length swimming pool invites residents to swim, exercise, and unwind by the water. Children can explore and play freely at the outdoor playground and wading pool. Here, recreation becomes a natural part of everyday living.



Wading Pool & Jacuzzi



Beach Pool

Resort-themed Ambiance

Beach Pool

Embodying the serenity of a private resort, the main highlight of the facilities podium is the beach pool; a refreshing oasis amidst lush surroundings. Complemented by BBQ pavilions, this vibrant social enclave brings residents together - for sunset swims, weekend cookouts and precious family moments.



BBQ Pavilions

Prioritising Wellness

Fully-Equipped Indoor Gym

At Hillview, wellness takes centre stage. The spacious, fully-equipped indoor gym is thoughtfully designed to support a wide range of workouts - from strength training and cardio to functional fitness. The comfortable indoor setting allows you to stay consistent with your fitness goals.



Bringing People Together

Shared Social Spaces



Here, life extends beyond your doorstep — into spaces that celebrate connection, creativity, and the art of living well. Whether you're working, gathering, or unwinding, each space is crafted to elevate the everyday.

The co-working space offers a calm, contemporary environment for productivity while the gourmet kitchen invites residents to cook, host, and share good food with great company.



Clubhouse

Entertainment & Gatherings

Indoor Facilities

Residents also have access to a private indoor cinema and a karaoke room, offering relaxed entertainment without leaving home. The multi-purpose hall doubles as a pickleball court, while the thoughtfully designed function room provides a flexible space for business meetings, large celebrations, or more intimate gatherings.



Private Cinema



Intelligently Crafted Spaces

Efficient Design, Spacious Interiors

Every home is thoughtfully planned to maximise space, flow and functionality. Efficient layouts ensure each area serves a purpose, creating seamless transitions between living, dining and private zones for everyday comfort.

Refined detailing and quality finishes further elevate the interiors, delivering a home that balances practicality with style and sophistication.



Thoughtfully-Planned Flow

Ground Floor Layout



Lifestyle Privileges

Level 7 Facilities

Designed to elevate daily living, the residence also offers world-class facilities – both indoor and outdoor – spread out across the lush landscaped grounds of the development. From active pursuits to spaces of quiet relaxation, each amenity is thoughtfully curated to nurture wellness, leisure, and connection.



- | | | | |
|-------------------------------|------------------|------------------------------|-------------------------|
| 1. Sunken Pod | 6. Swimming Pool | 11. Children Playground | 18. Quiet Seating Nooks |
| 2. Karaoke Room | 7. Pool Deck | 12. Horizon Retreat Pavilion | 19. Cove Pavilion |
| 3. Private Cinema | 8. Jogging Track | 13. BBQ Pavilions | 20. Reflective Pond |
| 4. Gymnasium | 9. Jacuzzi | 14. Pickleball Court/ MPH | 21. Beach Pool |
| 5. Eden Terrace Urban Farming | 10. Wading Pool | 15. Co-working Space | 22. Dune Lagoon |
| | | 16. Gourmet Kitchen | 23. Nature Trail |
| | | 17. Function Room | 24. Beach Deck |
| | | | 25. Yoga Deck |

The Perfect Location

Cultural, Entertainment, Administrative & Business Hub

Strategically located along the Selat Tebrau waterfront, Senibong Cove offers effortless access to everything that matters. From daily conveniences and education to business, leisure, recreation and healthcare, the township sits at the heart of it all; where every necessity and lifestyle choice is within easy reach.



Johor Bahru City Centre

- Upgrading of Central Business District
- Customs, Immigration and Quarantine Complex (CIQ)
- JB-Singapore Causeway
- Rapid Transit System (RTS) - Woodlands / Johor Bahru City

Iskandar Puteri

- Kota Iskandar (Johor State Administrative Centre)
- EduCity
- Medical Park
- Legoland

Western Gate Development

- Port of Tanjung Pelepas
- Tanjung Bin Power Plant
- Malaysia - Singapore Second Link
- RAMSAR World Heritage Site
- Tanjung Piai

Eastern Gate Development

- Tanjung Langsat Industrial Complex
- Tanjung Langsat Port
- Johor Port
- Pasir Gudang Industrial Park

Senai-Skudai

- Senai International Airport
- Senai Cargo Hub
- Senai High-Tech Park
- Sedenak Industrial Park
- MSC Cyberport City
- Johor Technology Park



- AEON Mall Permas Jaya
- REAL Schools and International Schools
- Permas Jaya Golf Club



- Mid Valley Southkey
- Giant Plentong
- Lotus's Plentong
- Regency Specialist Hospital
- Columbia Asia Hospital - Tebrau
- KPJ Pasir Gudang Specialist Hospital
- Daiman 18 Golf Course



- Bukit Chagar RTS Station
- Woodlands Checkpoint
- Komtar JBCC
- AEON Mall Tebrau City
- Toppen Shopping Centre
- Sultan Ismail Hospital
- Sultanah Aminah Hospital
- Ponderosa Golf & Country Club



Seamless Flow

Roadways & Public Transport

Major highways provide direct connectivity to Johor Bahru City Centre, the Johor–Singapore Causeway, and the Malaysia–Singapore Second Link — ensuring smooth cross-border access.

Rail connectivity is equally convenient. The Bukit Chagar RTS station provides seamless access into Singapore, while the Electric Train Service (ETS) links major Malaysian cities including Kuala Lumpur directly to Johor Bahru in under five hours.



11 km to RTS • Shuttle Services to RTS Station



13km to Singapore • 12km to JB City Centre • 30km to Senai International Airport

International Access

Meanwhile, the Senai International Airport places global destinations within easy reach. And for those drawn to the water, the Johor Port opens the door to international tourists while Senibong Cove's 50-berth marina offers yachting, water sports, and coastal leisure.





From Vision To Reality

WM Senibong is a multiple award-winning developer, renowned for its master-planned communities such as Senibong Cove, Crest@Austin, The Kews and Centennial ParcVista in Southern Malaysia. Managing a strategic landbank of over 2000 acres with a projected GDV of more than RM30 billion, WM Senibong is known for its placemaking approach; to create environment that prioritise human experience, well-being, and a sense of belonging; without compromising on design and value. At WM Senibong, we are committed to building and delivering sustainable communities to meet current needs without compromising those of future generations.

A Project By:



Developed By:

Senibong Hills Sdn Bhd 201201027041 (1011531-T)

N-01, Blok N, Pinggiran Senibong,
No. 1, Persiaran Senibong, Teluk Senibong,
81750 Masai, Johor, Malaysia.

T +60 7 382 0330

F +60 7 382 2600

E enquiries@wmsenibong.com.my

senibongcove.my



SenibongCoveMalaysia



senibongcovemalaysia



Senibong Cove Sales Gallery

• Developer's License No: 14523/08-2028/1047(A) • Validity Period: 21/08/2023 – 20/08/2028 • Advertisement & Sales Permit No.: XXXXXXXXXXXXXXXXXXXX • Validity Period: XXXXXXXXXXXXXXXXXXXX • Building Type: Tower A: Serviced Apartment • Total Units: 416
• Selling Price: RM452,000.00 (min) – RM1,191,000.00 (max) • Approving Authority: Majlis Bandaraya Johor Bahru • Reference No.: MBJB/U/2025/14/BGN/32/KOM • Land Tenure: Freehold • Land Encumbrances: AmBank (M) Berhad • Expected Date of Completion:
March 2029 • Total Car Park Allocation: Tower A: 551 • 15% discount for Bumiputera

Restriction in interest:

- Tuan punya tanah tidak dibenarkan menawarkan atau menjual unit-unit (parcels) bangunan yang akan dibina di atas tanah ini melainkan bangunan telah mula dibina mengikut pelan yang diluluskan oleh Pihak Berkuasa Tempatan yang berkenaan.
- Petak-petak bangunan yang didirikan di atas tanah ini apabila sahaja bertukar miliknya kepada seorang Bumiputera/Syarikat Bumiputera maka tidak boleh terkemudian daripada itu dijual, dipajak atau dipindahmilik dengan apa cara sekalipun kepada orang Bukan Bumiputera/Syarikat Bukan Bumiputera tanpa persetujuan Pihak Berkuasa Negeri.
- Petak-petak bangunan yang didirikan di atas tanah ini tidak boleh dijual atau dipindahmilik dengan apa cara sekalipun kepada Bukan Warganegara/Syarikat Asing tanpa persetujuan Pihak Berkuasa Negeri.

THIS ADVERTISEMENT HAS BEEN APPROVED BY THE NATIONAL HOUSING DEPARTMENT.
DEVELOPMENT INFORMATION AND APPROVED ADVERTISEMENT CAN BE VIEWED THROUGH THE TEDUH.KPKT.GOV.MY PORTAL